

**Mini-Mule**  
Manufactured By DEUER

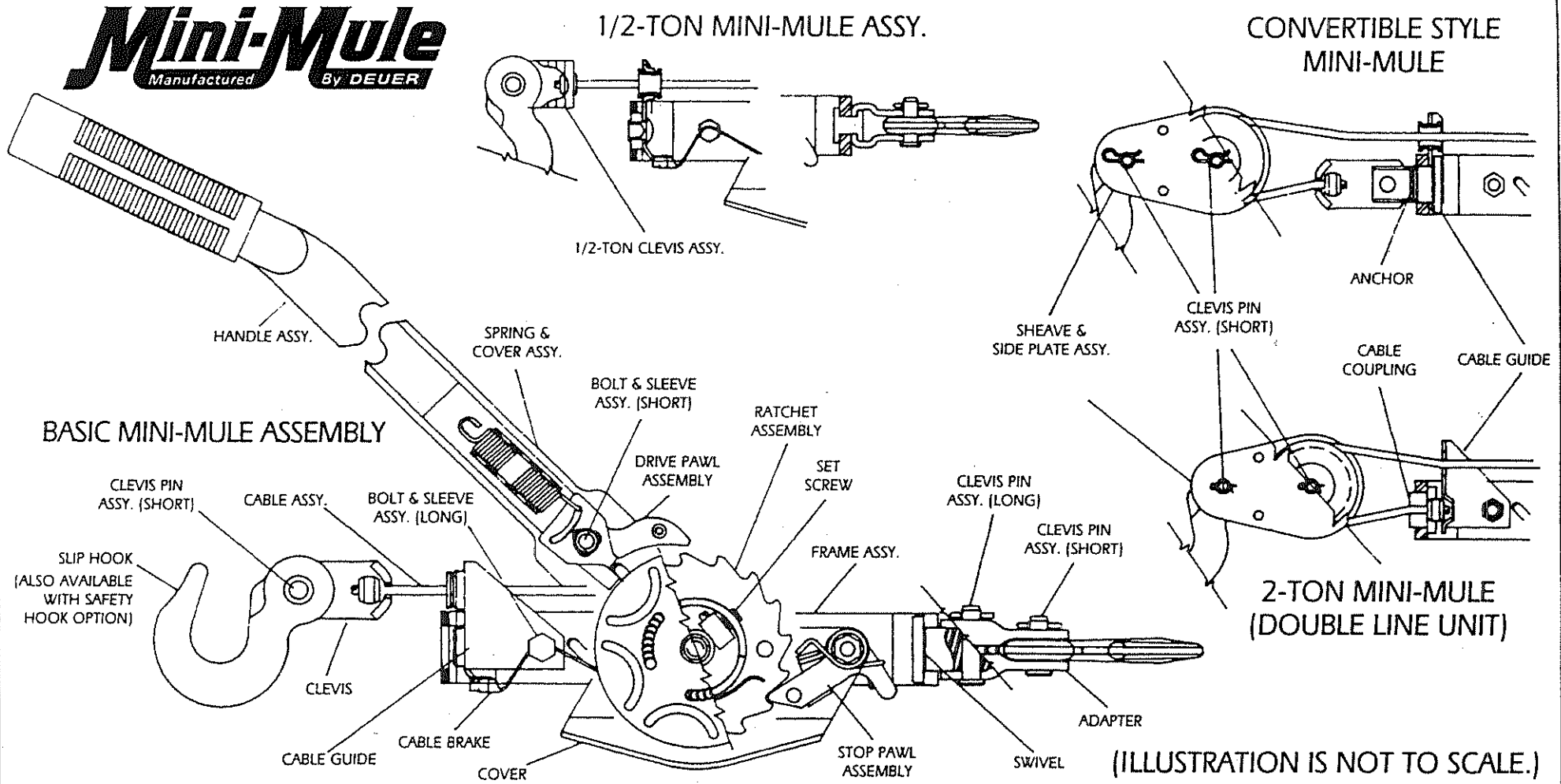

Please order replacement parts for your particular style of MINI-MULE using the "Model Number" and "Description" listed below, the name of the desired part as shown in the illustration above, and the quantity required.

1. Determine the "Description" by matching the "Model Number" as listed with the number stamped on the cover of your MINI-MULE.
2. When ordering give the Model Number and Description then give the required part name and the desired quantity.

EXAMPLE: MM16R / 1-ton regular drive / cable assembly / 2 each.  
MM212DD / 2-TON DOUBLE DRIVE / HANDLE ASSEMBLY / 1 ea.

3. Order through your dealer or contact: DEUER MANUFACTURING, INC.  
DAYTON, OH USA  
1-866-489-MULE (6853)

MODEL NUMBER	DESCRIPTION	MODEL NUMBER	DESCRIPTION
MM5014	1/2-TON UNIT, REGULAR DRIVE	MM16DD	1-TON-UNIT, DOUBLE DRIVE
MM5028	1/2-TON UNIT, REGULAR DRIVE	MM19DD	1-TON UNIT, DOUBLE DRIVE
MM7518	3/4-TON UNIT, REGULAR DRIVE	MM112DD	1-TON UNIT, DOUBLE DRIVE
MM16R	1-TON UNIT, REGULAR DRIVE	MM212DD	2-TON UNIT, DOUBLE DRIVE
MM19R	1-TON UNIT, REGULAR DRIVE	MM1212CDD	1 OR 2-TON, DOUBLE DRIVE
MM112R	1-TON UNIT, REGULAR DRIVE		
MM212R	2-TON UNIT, REGULAR DRIVE		
MM1212C	1 OR 2-TON, REGULAR DRIVE		

**Mini-Mule**  
Manufactured By DEUER

THIS IS YOUR



HOIST PULLER

Patent N. 3,985,342

LIMITED SIX (6) MONTH WARRANTY TO ORIGINAL USING BUYER

ALL MINI-MULE Hoist-Pullers, when operated under normal conditions, within their rated capacities, and in accordance with the instructions received with the product are warranted against defects in materials or workmanship for six months from date of purchase by the original using buyer.

Any part or unit recognized as defective by DEUER MFG. will be repaired or replaced without charge during this period, if it is returned, prepaid, to the factory.

This warranty shall not apply if the unit has been altered, repaired or modified outside the warrantor's factory or if the cable has been frayed or broken due to misuse such as being bent over sharp corners or wrapped around an object and hooked back on itself.

This warranty does not cover any claim for labor, delays or damages.

While this warranty gives your specific rights, you may also have other rights which vary from state to state.

★ ★ ★ ★ CAUTION ★ ★ ★ ★

1. Read and understand the OPERATING INSTRUCTIONS on your MINI-MULE Hoist-Puller before using.
2. DO NOT exceed rated or specified load limits.
3. DO NOT subject MINI-MULE Hoist-Puller to sudden shock loads.
4. Operate the MINI-MULE Hoist-Puller with manual power only.
5. DO NOT use the MINI-MULE Hoist-Puller as, or in place of a tow cable.
6. Use the MINI-MULE Hoist-Puller for straight pulling or lifting only. DO NOT SIDE LOAD.
7. ALWAYS have a minimum of 2 wraps of cable on the drum.
8. NEVER stand in front of – or in line with a pretensioned unit.
9. DO NOT use extension bar on handle. Handle is designed to bend if overloaded.
10. DO NOT operate MINI-MULE Hoist-Puller with frayed, kinked, twisted or damaged cable.
11. DO NOT lift people or loads over people.
12. DO NOT wrap cable over any sharp edge or secure any object by bringing hook back onto cable.

★ ★ ★ ★ OPERATING INSTRUCTIONS ★ ★ ★ ★

1. TO RAISE LOAD OR APPLY TENSION – Push on the spring & cover assembly to cause the drive pawl arm to engage the ratchet tooth.
2. TO LOWER OR RELEASE TENSION – Push on the spring & cover assembly to cause the drive pawl arm to dis-engage the ratchet tooth. Rotate the handle till the drive pawl engages and operates the release lever of the stop pawl assembly. Relieve pressure on the handle to allow the load to descend one notch at a time. Repeat till the load is grounded and no more tension is applied to the unit.
3. WHEN LOAD TENSION HAS BEEN COMPLETELY REDUCED – The cable may be pulled out by hand while holding the stop pawl assembly dis-engaged from the ratchet tooth with your other hand.
4. CONVERTING THE MM1212 MINI-MULE FROM 1-TON TO 2-TON CAPACITY – Remove the clevis pin and hairpin cotter from the anchor at the sheave end of the frame assembly. Remove both clevis pins and hairpin cotters from the sheave assembly. Place the eye of the hook between the sides of the clevis at the free end of the cable. Insert a clevis pin and hairpin cotter to secure the hook to the clevis. Retain un-used parts of the sheave assembly for future use.
5. UNIQUE QUICK-CHANGE CABLE REPLACEMENT DESIGN – Pull all the cable off the ratchet wheel. Remove the set screw from the barrel of the ratchet and retain. Snap the old cable out of the specially designed “keyhole.” Snap in the replacement cable assembly. Re-install the set screw securely. While applying slight tension to the new cable assembly, wind the cable onto the barrel of the ratchet wheel assembly.